

AMENDED DRAWING

- NOTES**
- All dimensions and levels are to be checked on site.
 - Any discrepancies are to be reported to the Shaw & Jagger Architects Ltd before any work commences.
 - This drawing shall not be scaled to ascertain any dimensions. Work to figured dimensions only.
 - This drawing shall not be reproduced without express written permission from Shaw & Jagger Architects Ltd.
 - Title overlay drawings and ownership boundaries are produced using all reasonable endeavors. Shaw & Jagger Architects Ltd cannot be responsible for the accuracy or scale discrepancy of base plans supplied to them.

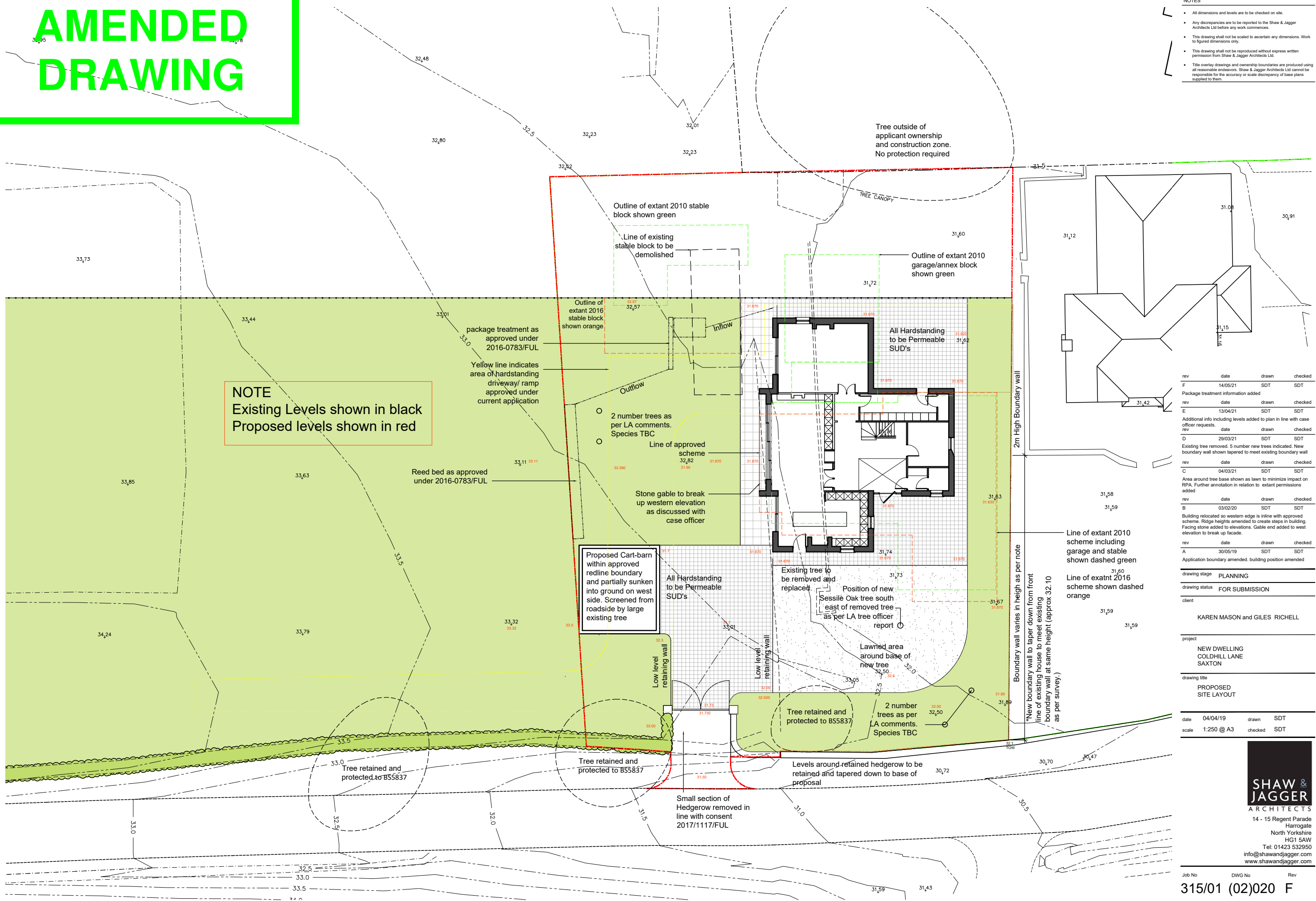

NOTE
Existing Levels shown in black
Proposed levels shown in red

rev	date	drawn	checked
F	14/05/21	SDT	SDT
Package treatment information added			
rev	date	drawn	checked
E	13/04/21	SDT	SDT
Additional info including levels added to plan in line with case officer requests.			
rev	date	drawn	checked
D	29/03/21	SDT	SDT
Existing tree removed. 5 number new trees indicated. New boundary wall shown tapered to meet existing boundary wall			
rev	date	drawn	checked
C	04/03/21	SDT	SDT
Area around tree base shown as lawn to minimize impact on RPA. Further annotation in relation to extant permissions added			
rev	date	drawn	checked
B	03/02/20	SDT	SDT
Building relocated so western edge is inline with approved scheme. Ridge heights amended to create steps in building. Facing stone added to elevations. Gable end added to west elevation to break up facade.			
rev	date	drawn	checked
A	30/05/19	SDT	SDT
Application boundary amended, building position amended			

drawing stage **PLANNING**
drawing status **FOR SUBMISSION**

client
KAREN MASON and GILES RICHELL

project
**NEW DWELLING
COLDHILL LANE
SAXTON**

drawing title
**PROPOSED
SITE LAYOUT**

date **04/04/19** drawn **SDT**
scale **1:250 @ A3** checked **SDT**

SHAW & JAGGER
ARCHITECTS
14 - 15 Regent Parade
Harrogate
North Yorkshire
HG1 5AW
Tel: 01423 532950
info@shawandjagger.com
www.shawandjagger.com

Job No **315/01 (02)020** Rev **F**